

Specifications

Terminal Material: Copper
Braze Seam
Plating: Electro Tin Plated

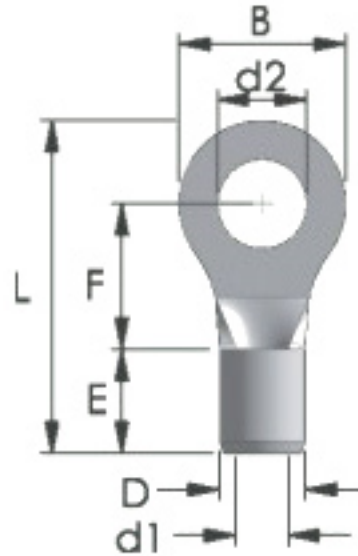

Part Number

SCBR5-4SNB

Wire Range	Stud Size d2	Dimensions mm (inch)					
		B	L	F	E	D	d1
4 ~ 6mm ² 12 ~ 10 AWG	4.3 #8	7.2 (0.283)	15.5 (0.610)	5.9 (0.232)	6.0 (0.236)	5.6 (0.236)	3.4 (0.134)