

## Specifications

### Material

Contact: Brass

Plated: Tin

Thickness: 0.762mm (0.03")

Mounting Holes: 1.32mm (0.052")

### Features

Vertical Configuration Type Terminal

Offers Quick Connecting & Disconnecting of Female  
Terminals

## Part Number

PCK-1287

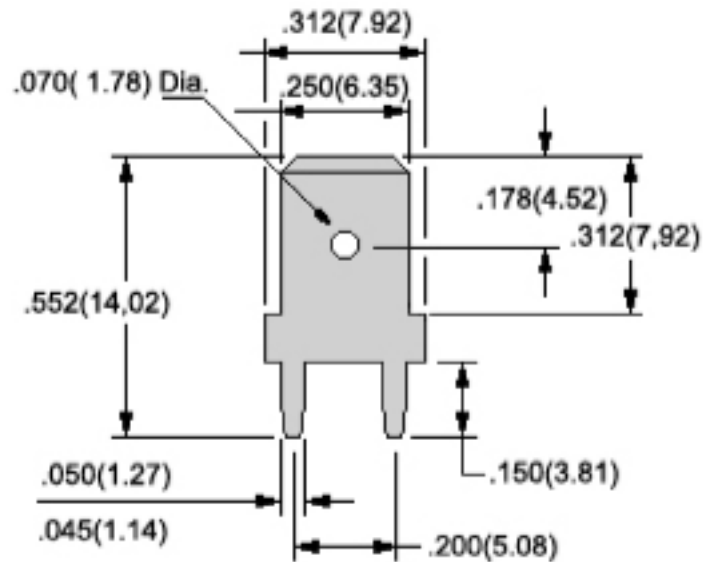

Units: Inches (mm)