

Specifications

Material

Contact: Brass

Plated: Tin

Thickness: 0.762mm (0.03")

Mounting Holes: 1.32mm (0.052")

Features

Vertical Configuration Type Terminal

Offers Quick Connecting & Disconnecting of Female
Terminals

Part Number

PCK-1212

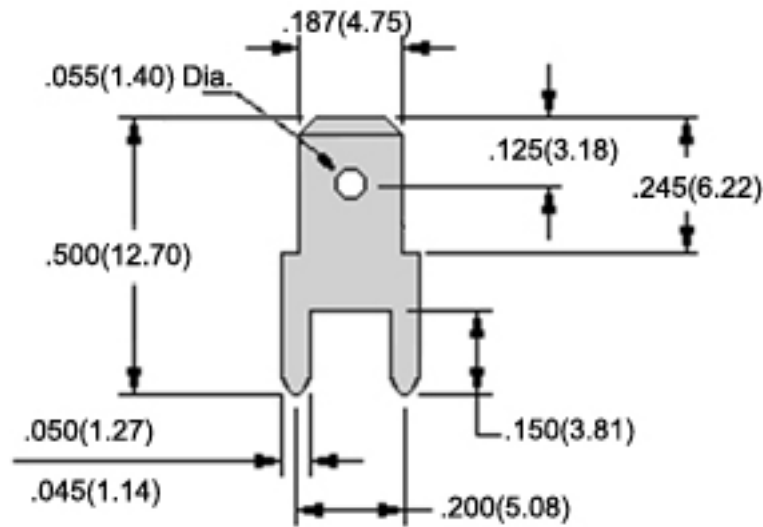

Units: Inches (mm)