



BOARD LEVEL COOLING – Extruded 5310

Extruded 5310 is a series of dual radial board level heat sinks designed to cool TO-202 and TO-220 devices. Representative image only.

ORDERING INFORMATION

| Part Number | Device Type |
|---------------|----------------|
| 531002B00000G | TO-202, TO-220 |
| 531002B02100G | TO-202, TO-220 |
| 531002B02500G | TO-220 |
| 531102B00000G | TO-202, TO-220 |
| 531102B02100G | TO-220 |
| 531102B02500G | TO-220 |
| 531102V02500G | TO-220 |
| 531202B00000G | TO-202, TO-220 |
| 531202B02100G | TO-202, TO-220 |
| 531202B02500G | TO-202, TO-220 |
| 531302B02500G | TO-202, TO-220 |



HEAT SINK DETAILS

| Property | Details |
|----------------------------|-----------------------|
| Material | Aluminum |
| Finish | Black Anodize |
| Finish: 531102V02500G | AavSHIELD3 |
| Device Attachment Options | Requires Mounting Kit |
| Thermal Interface Material | - |

| Property | Details |
|------------------------------|-------------------|
| Heat Sink Width (mm) | 34.92 |
| Heat Sink Length (mm) | 12.70 |
| Heat Sink Height (mm) | See "H" Dim below |
| Heat Sink Mounting Direction | Vertical |

MECHANICAL & PERFORMANCE

Drawing dimensions are shown in mm, (in)

| Part Number | "H" Dim | "X" Dim | "Y" Dim | "Z" Dim |
|---------------|---------|---------------|-------------|--------------|
| 531002B00000G | 25.40 | - | - | - |
| 531002B02100G | 25.40 | 12.70 (0.500) | .79 (0.031) | 2.67 (0.105) |
| 531002B02500G | 25.40 | 12.70 (0.500) | .79 (0.031) | 2.67 (0.105) |
| 531102B00000G | 38.10 | - | - | - |
| 531102B02100G | 38.10 | 12.70 (0.500) | .79 (0.031) | 2.67 (0.105) |
| 531102B02500G | 38.10 | 12.70 (0.500) | .79 (0.031) | 2.67 (0.105) |
| 531102V02500G | 38.10 | 12.70 (0.500) | .79 (0.031) | 2.67 (0.105) |
| 531202B00000G | 50.80 | - | - | - |
| 531202B02100G | 50.80 | 12.70 (0.500) | .79 (0.031) | 2.67 (0.105) |
| 531202B02500G | 50.80 | 12.70 (0.500) | .79 (0.031) | 2.67 (0.105) |
| 531302B02500G | 63.50 | 12.70 (0.500) | .79 (0.031) | 2.67 (0.105) |

Part Number: 531002B00000G

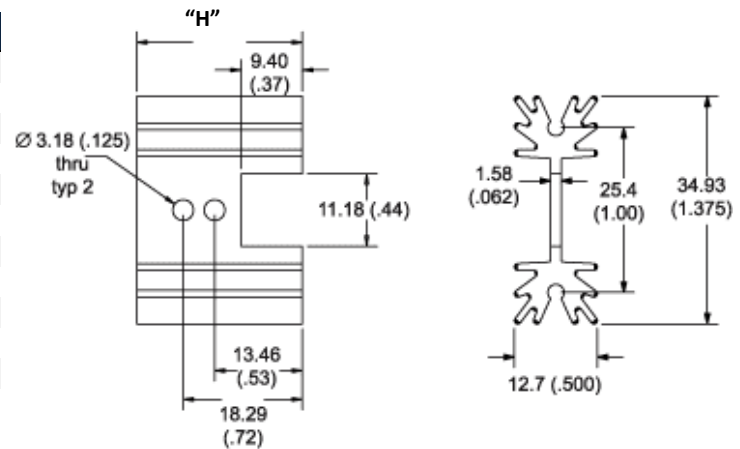

Board Level Cooling – Extruded 5310

Part Number: 531002B02100G

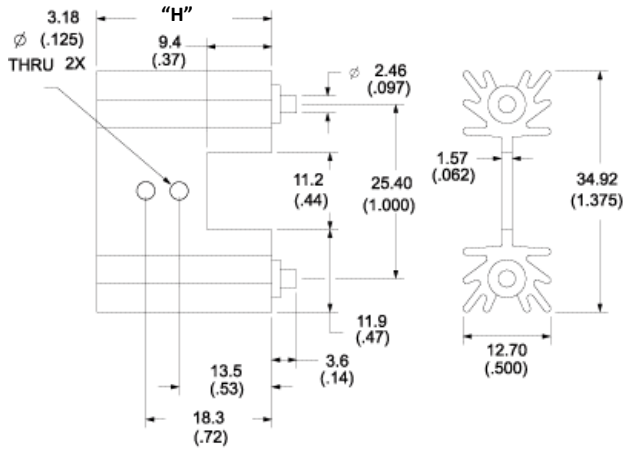

Part Number: 531102B02100G

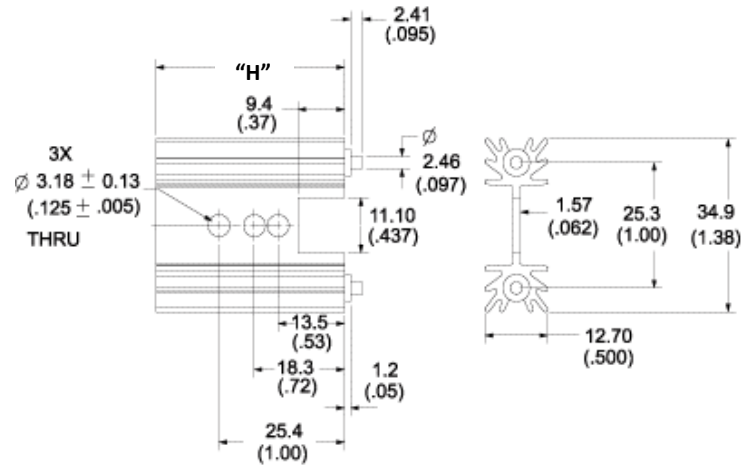

Part Number: 531002B02500G

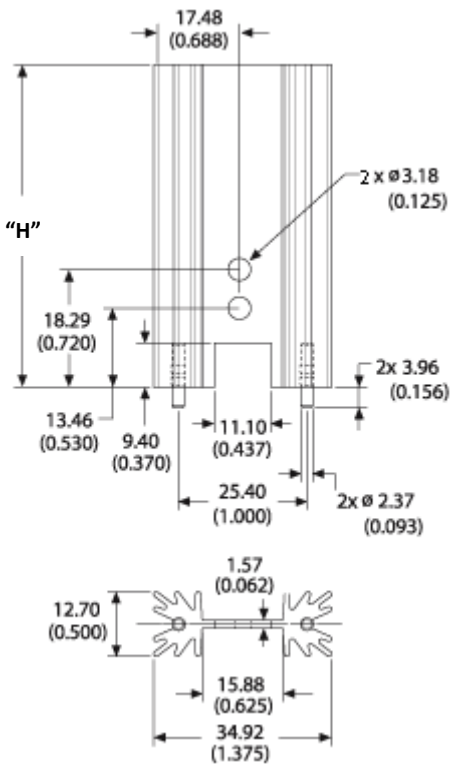

Part Number: 531102B00000G

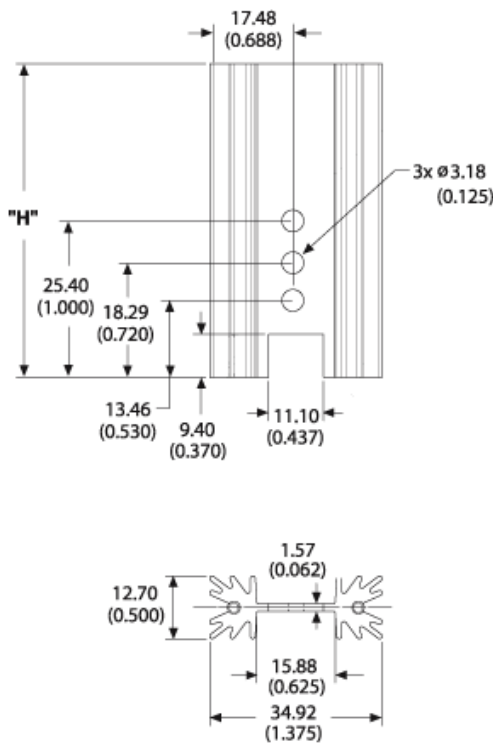

Part Number 531202B00000G

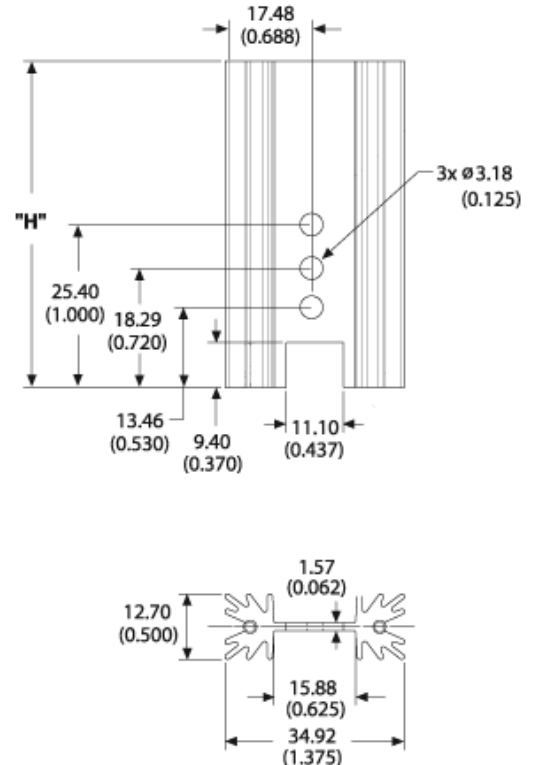

Board Level Cooling – Extruded 5310

Part Number: 531102B02500G, 531102V02500G,
531202B02100G, 531202B02500G, 531302B02500G

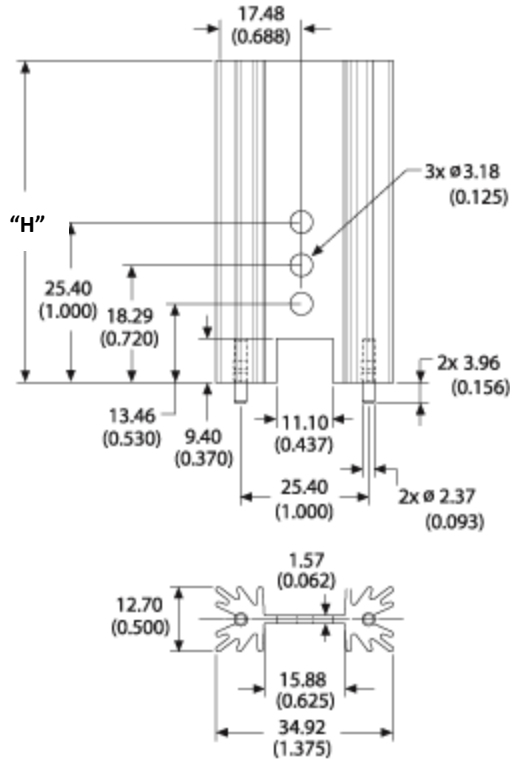

Mounting Details:

