

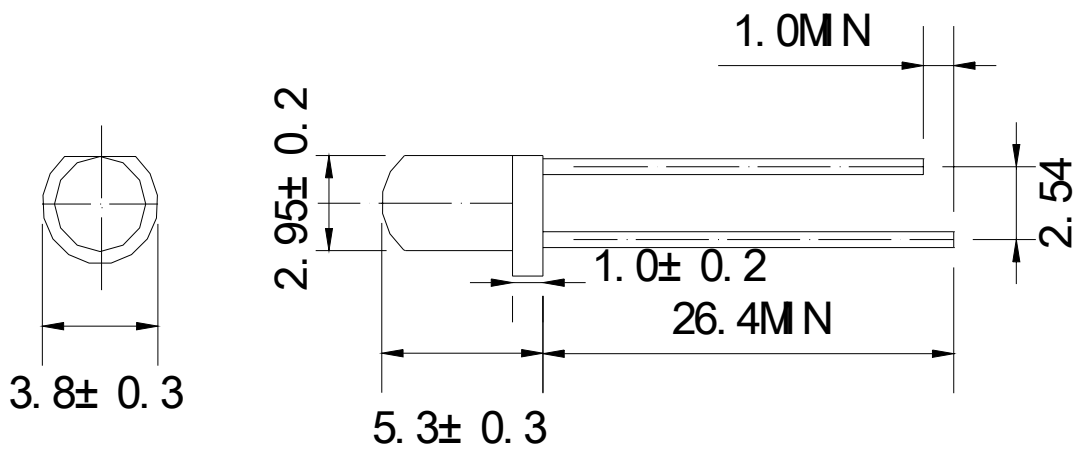

★ Package Dimensions



NOTE:

- 1.All dimensions are in millimeter.
- 2.Lead spacing is measured where the lead emerge from the package.

★ Selection Guide

Part NO.	Chip		Lens Color	Viewing Angle $2\theta_{1/2}$ (deg)
	Material	Emitted Color		
3-22b-CD43	GaP	Green	Green Diffused	40



Part No:3-22b-CD43

Absolute Maximum Ratings

(Ta=25 °C)

Parameter	Symbol	MAX. Rating	Unit
Power Dissipation	Pd	80	mW
Continuous Forward Current	IF	30	mA
Pak forward current (10 μs Pulse)	IFM	100	mA
Reverse Voltage	VR	5.0	V
Operating Temperature	Topr	-40~+85	
Storage Temperature	Tstg	-40~+85	
Lead Soldering Temperature (1.6mm From Case Bottom 260 °C For 5 SEC)			

Electric-Optical Characteristics

Parameter	Symbol	Test Condition	MIN	TYP	MAX	Unit
Forward Voltage	VF	IF=20mA		2.1	2.6	V
Reverse Voltage	VR	IR=10uA	5			V
Luminous Intensity	IV	IF=20mA	15	25		mcd
Peak Emission Wavelength	P	IF=20mA		565		nm
Spectrum Width Of Half Value		IF=20mA		30		nm

Characteristics Diagrams

Green (GaP)

